

Capacity: 10 / 15 / 20 t

GD-1

Standard air hydraulic single ram pit jack

- Rapid and precise air hydraulic unit with high speed ram travel
- Simple modern design with control panel at ergonomical working height
- Can be made to fit all pits due to its adjustable frame
- Frame height is adjusted and set to the customers individual specifications
- Fitted with leaf spring support bearings for easy glide transversing ram
- Comprehensive option range: cross beam, gearbox saddle, support bridge etc.
- *When ordering fill out specification form*

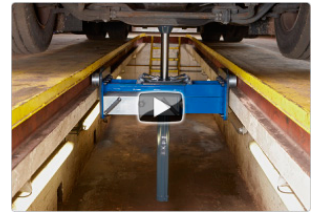

Technical data

	GD100-1	GD150-1	GD200-1
Capacity	10 t	15 t	20 t
Stroke	800 mm	800 mm	800 mm
Min. height	1020 mm	1020 mm	1020 mm
Max. height	1820 mm	1820 mm	1820 mm
Width ¹	590-1410 mm	590-1410 mm	590-1410 mm
Depth	665 mm	665 mm	
Air supply	8-12 bar	8-12 bar	8-12 bar
Air consumption	350 l/min	350 l/min	350 l/min
Weight	220 kg	220 kg	220 kg

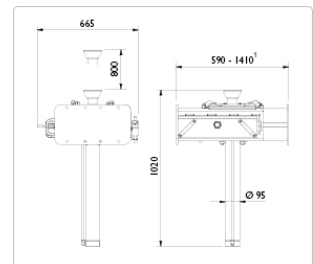

¹ Framewidth: 590-890 mm / 850-1150 mm / 1110-1410 mm

Accessories



